

ZOOMTEC SERIES



Narrow Spotlight



Flood Spotlight

Vertical



Horizontal



Product features

Anything is possible with ZOOMTEC. In versions with adjustable light distributions beam angle from 25-60deg, ZOOMTEC covers the full beam width of lighting requirements in shops, galleries and museums – high-contrast accent lighting, floodlighting of exhibits, uniform illumination of walls, or sharp edged beams for striking effects.

With innovative photometrics, ZOOMTEC combines efficiency with visual comfort.

To ensure excellent heat management and flawless performance, ZOOMTEC has separated the light head and control gear and at the same time, the combination of sharp edge bearbox and cylinder creates the visual impression of less volume and a classic design.

Range of Application

Commercial
Architectural
Museum / Art gallery



Accentuation

Emphasis of objects or architectural elements.

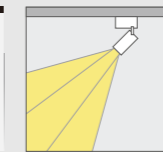
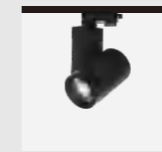

Track spotlights

Very narrow to wide beam, Rotateally symmetrical light distribution for accent lighting.

LED

Wattage:22-50W
Lumen:1407-3500lm
Light distribution:
Narrow
Medium
Flood



Accentuation

Emphasis of objects or architectural elements.

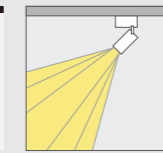
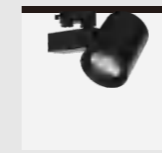

Track spotlights

narrow to wide beam, Rotateally symmetrical light distribution for accent lighting.

LED

Wattage:22-50W
Lumen:1407-3500lm
Light distribution:
Narrow
Medium
Flood



Suitable for indoor use



Protection level is IP20



High efficiency Lens



Comply with CE certification



The electrical grade is class1



CRI > 80 (standard)
CRI > 90 (optional)

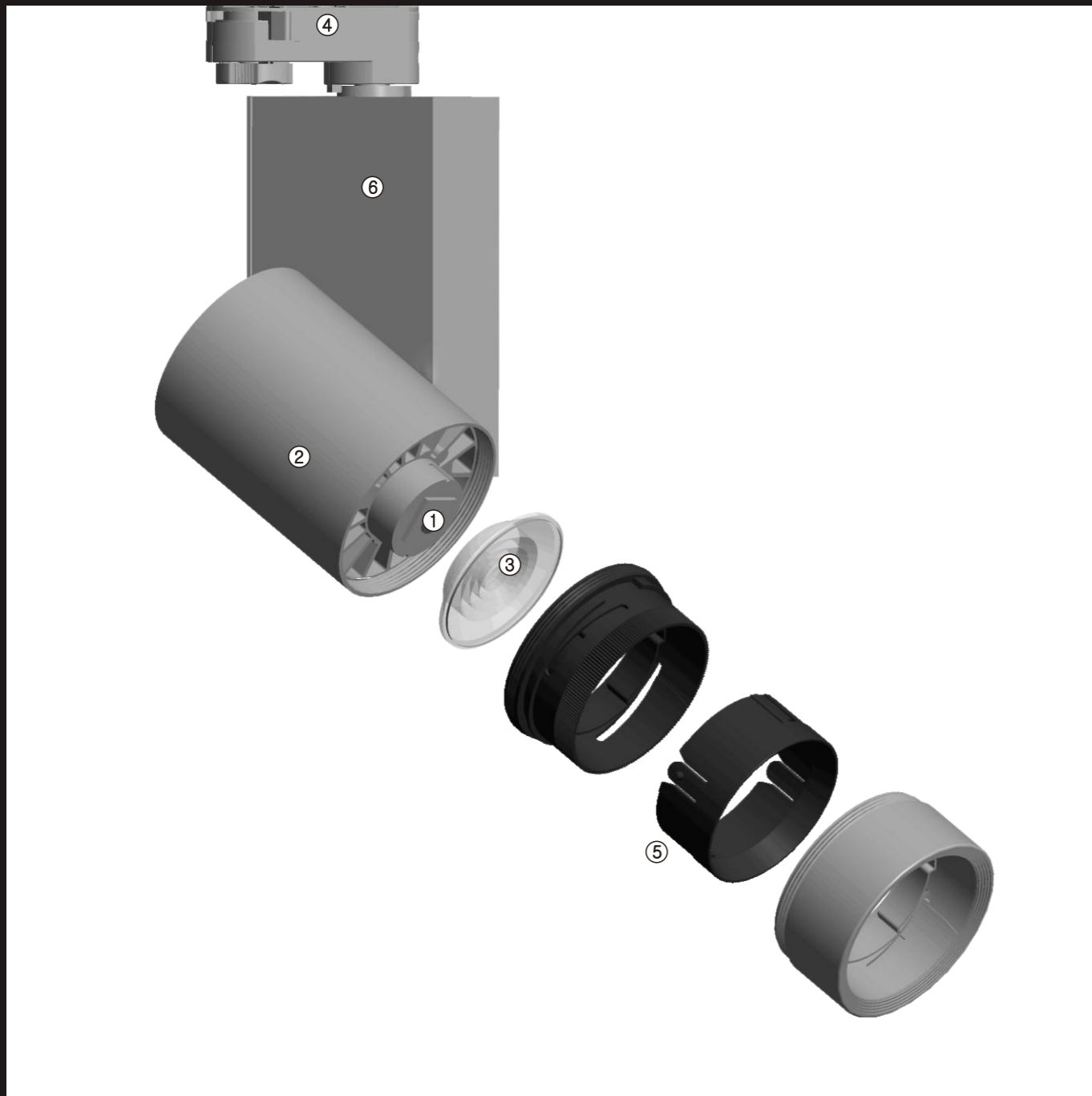

1: LED

High-power LED COB (Chip on board), offering high performance in an easy to use platform.
Light colors: Warm White, Neutral White, Cool White .

2: Housing

Made of die-casting aluminum and designed in support of the heat dissipation function. The latest heat dissipation housing, with optimized heat dissipation structure, which facilitate the heat exchange quickly from aluminum alloy die-casting housing to the air.

3: Lens system

Transparent polycarbonate lens cover, with >80% diffusing efficiency.

4:Adapter

Providing adapters of 2 phase, 3 phase and 4 phase in order to meet requirements of installation.

5: Twist adjustment device

Housing with COB & Lens adjustment structure can effectively re-adjust the beam angle of the best beam angle to suit your application. The beam angle can be adjusted from 20deg-50deg.

6: Control gear

Switchable, phase dimmable or DALI dimmable
Phase dimmable version: dimming with external dimmers possible (trailing edge)



Angle of adjustment

Smooth mechanical structure that tilt 90° on both side and an swing angle of 355° that has an intergrated ratchets. The ratchets structure improve the rotational smoothness and give an quality feel and sound when it rotates.

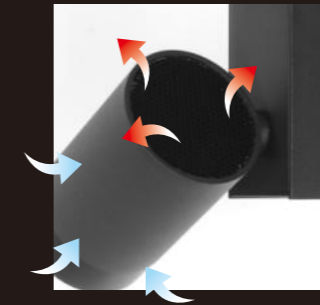

**High efficiency
dissipation heat sink**

Housing body construction serves as a cooling system designed to dissipate heat faster from the LED, also providing maximum air flow from the entire operation caused by rising hot air. When the operation temperature has been minimized the LED are guaranteed for it's maximum life time and performance.

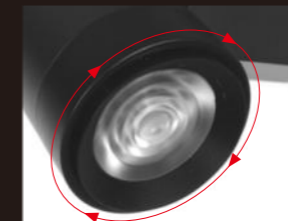

ZOOMTEC

Anything is possible with ZOOMTEC. In versions with adjustable light distributions beam angle form 25°-60°, ZOOMTEC covers the full beam width of lighting requirements in shops, galleries and museums high-contrast accent lighting, lloodlighting of exhibits, uniform illumination of walls, or sharpedged beams for striking effects.

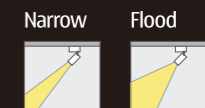
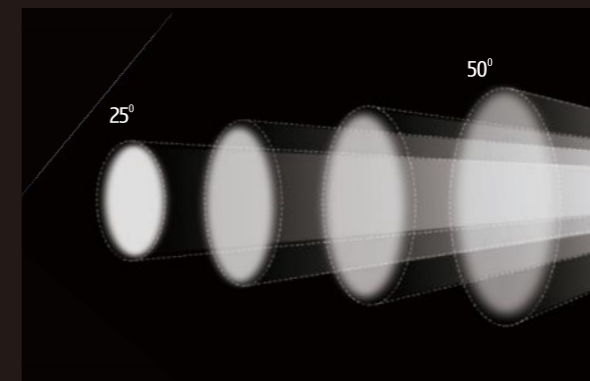

SMALL ZOOMTEC VERTICAL GEARBOX SERIES
LED TRACK SPOT LIGHT

80



IP20 | CE | CB |

Body: Die-cast aluminium
Housing: Die-cast aluminium
Optic: High efficiency Lens
Weight: 0.81 kg
CTN: 18PCS

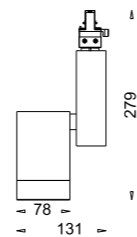

White
 Black
 Silver

ORDERING CODE	Power (W)	Beam Angle (°)	CCT (K)	Hot Lumen (Lm)	LOR (%)	UGR	On/Off	DRIVER 1-10V	DALI	Triac
ZLV800-W/B/S-830	32	20-40	3000	2600	84%	<19	✓	✓	✓	✓
ZLV800-W/B/S-840			4000	2698						
ZLV800-W/B/S-850			5000	2752						

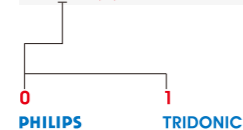

Anti-glare: RBP80

PHILIPS SLM C 830 1205 L12 G1

3000K

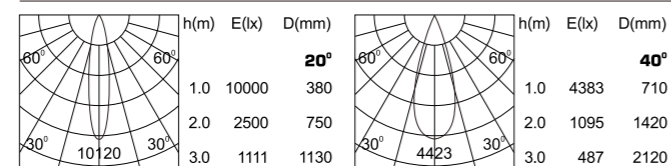

MEDIUM ZOOMTEC VERTICAL GEARBOX SERIES
LED TRACK SPOT LIGHT

100

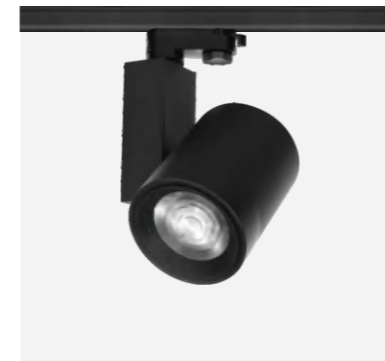

IP20 | CE | CB |

Body: Die-cast aluminium
Housing: Die-cast aluminium
Optic: High efficiency lens
Weight: 1.0kg
CTN: 12PCS

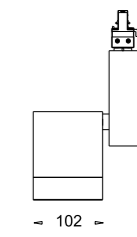

White
 Black
 Silver

ORDERING CODE	Power (W)	Beam Angle (°)	CCT (K)	Hot Lumen (Lm)	LOR (%)	UGR	On/Off	DRIVER 1-10V	DALI	Triac
ZLV1000-W/B/S-830	41	20-50	3000	3609	79%	<19	✓	✓	✓	✓
ZLV1000-W/B/S-840			4000	3785						
ZLV1000-W/B/S-850			5000	3641						

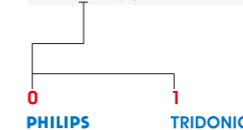

Anti-glare: RBP102

PHILIPS SLM C 830 1208 L14 G1

3000K

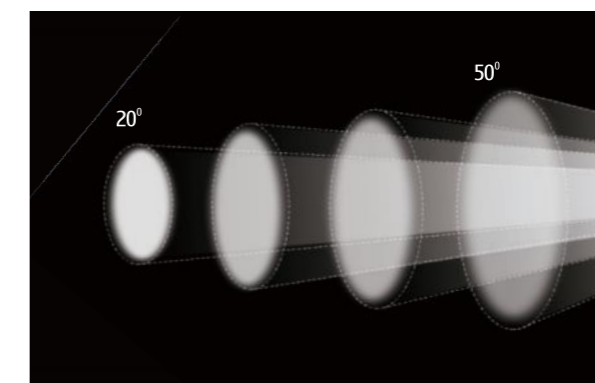
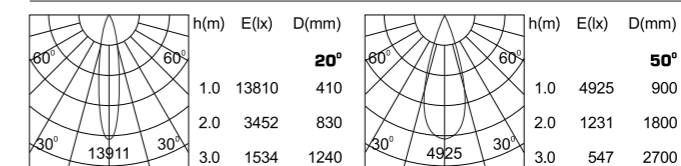



**SMALL ZOOMTEC HORIZONTAL GEARBOX SERIES
LED TRACK SPOT LIGHT**

80



IP20 | CE | CB |

Body: Die-cast aluminium
Housing: Die-cast aluminium
Optic: High efficiency lens
Weight: 0.81 kg
CTN: 16PCS

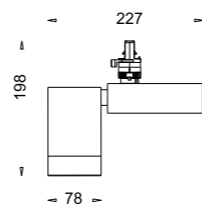

White Black Silver

ORDERING CODE	Power (W)	Beam Angle (°)	CCT (K)	Hot Lumen (Lm)	LOR (%)	UGR	On/Off	DRIVER 1-10V	DALI	Triac
ZLH800-W/B/S-830	32	20-40	3000	2600	84%	<19	✓	✓	✓	✓
ZLH800-W/B/S-840			4000	2698						
ZLH800-W/B/S-850			5000	2752						



Anti-glare: RBP80

PHILIPS SLM C 830 1205 L12 G1

3000K

h(m)	E(lx)	D(mm)	h(m)	E(lx)	D(mm)
20°			40°		
1.0	10000	380	1.0	4383	710
2.0	2500	750	2.0	1095	1420
3.0	1111	1130	3.0	487	2120



**MEDIUM ZOOMTEC HORIZONTAL GEARBOX SERIES
LED TRACK SPOT LIGHT**

100

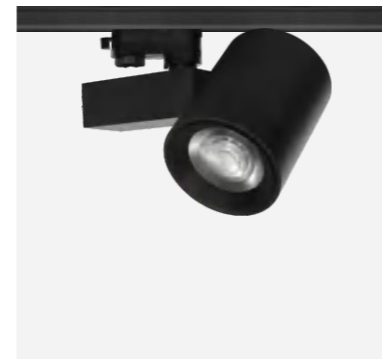

IP20 | CE | CB |

Body: Die-cast aluminium
Housing: Die-cast aluminium
Optic: High efficiency lens
Weight: 1.0kg
CTN: 12PCS

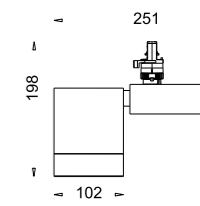

White Black Silver

ORDERING CODE	Power (W)	Beam Angle (°)	CCT (K)	Hot Lumen (Lm)	LOR (%)	UGR	On/Off	DRIVER 1-10V	DALI	Triac
ZLH1000-W/B/S-830	41	20-50	3000	3609	79%	<19	✓	✓	✓	✓
ZLH1000-W/B/S-840			4000	3785						
ZLH1000-W/B/S-850			5000	3641						



Anti-glare: RBP102

PHILIPS SLM C 830 1208 L14 G1

3000K

h(m)	E(lx)	D(mm)	h(m)	E(lx)	D(mm)
20°			50°		
1.0	13810	410	1.0	4925	900
2.0	3452	830	2.0	1231	1800
3.0	1534	1240	3.0	547	2700



**Interchangeable
Socket System (ISS)**

Simple solderless interchangeable socket system (ISS) that make it possible for quick and easy maintenance of LED/COB modules. The ISS system is compatible with most popular brands COB such like, Philips, Osram, Tridonic, Citizen & CREE. ISS has an special locking that made it possible to add other accessories or secondary optics. Best of all installation are simple and extremely friendly to apply.